

CP Type / Maximum sealing

The rivet provides maximum air sealed fastening, thanks to its plastic cap. It also prevents galvanic corrosion between different metals.



[MOVIE] http://www.byora.co.jp/index/products/movies/blind_cp.html

Symbols of standard dimensions and installation diagram

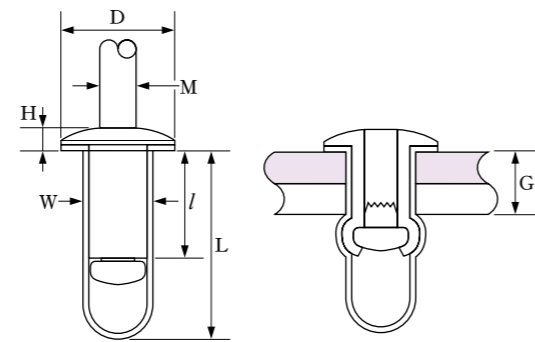

Product code

D AS 543 CP

① ② ③ ④

- ① Flange shape code (D: Round head)
- ② Material code (AS and AA * See the specification table.)
- ③ Size code (* See the specification table.)
- ④ Rivet type (CP)

Airtightness

There will be no water leakage under the pressure test conditions below.

Product	DAS543
Work hole diameter	4.1 mm
Pressurizing time	8 hours
Pressure	0.9 MPa

AS specification table

AS (Sleeve: Aluminum A5154 / fabric, Mandrel: Hard steel wire / zinc plating)

Sleeve diameter W(mm)	Mating hole diameter (mm)	Size code	Recommended fastening range G (mm)	l	L ^{*1}	Round head (mm)		M (mm)	Strength ^{*2} (kN)	
						D	H		Tensile	Shear
4.0	4.1	541	1.0 ~ 1.6	4.6	12.0	6.4	1.3	1.85	1.1	0.9
		542	1.6 ~ 3.2	6.2						
		543	3.2 ~ 4.8	7.8						

AA specification table

AA (Sleeve: Aluminum A5052 / fabric, Mandrel: High-tensile aluminum wire / fabric)

Sleeve diameter W(mm)	Mating hole diameter (mm)	Size code	Recommended fastening range G (mm)	l	L ^{*1}	Round head (mm)		M (mm)	Strength ^{*2} (kN)	
						D	H		Tensile	Shear
4.0	4.1	541	1.0 ~ 1.6	4.9	12.0	6.4	1.3	2	0.4	0.66
		542	1.6 ~ 3.2	5.7						
		543	3.2 ~ 4.8	7.3						

This product is made to order.

*1. The L lengths are given as guidelines. *2. The strength values are obtained through our own testing.

- Remarks) (1) The steel mandrel is plated with zinc. For trivalent chromate plating, please ask us.
 (2) The standard dimensions are subject to change without notice.
 (3) Please ask us when the required fastening range exceeds the recommended range or when it is near lower limit.

GT Type / High strength clamping

The large-diameter fastens the workpieces tightly together.



[MOVIE] http://www.byora.co.jp/index/products/movies/blind_gt.html

Symbols of standard dimensions and installation diagram

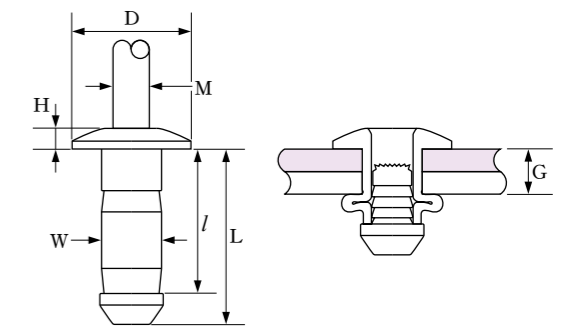

Product code

D CC 66 GT

① ② ③ ④

- ① Flange shape code (D: Round head)
- ② Material code (CC * See the specification table.)
- ③ Size code (* See the specification table.)
- ④ Rivet type (GT)

CC specification table

CC (Sleeve: Austenitic stainless steel / fabric, Mandrel: High-tensile stainless steel wire / fabric)

Sleeve diameter W(mm)	Mating hole diameter (mm)	Size code	Recommended fastening range G (mm)	l	L ^{*1}	Round head (mm)		M (mm)	Strength ^{*2} (kN)	
						D	H		Tensile	Shear
4.8	4.9	62	1.6 ~ 3.2	9.5	12.0	9.5	1.7	3.2	5.4	4.5
		64	3.2 ~ 4.8	12						
		66	6.4 ~ 8.6	15						

*1. The L lengths are given as guideline. *2. The strength values are obtained through our own testing.

Remarks) (1) The standard dimensions are subject to change without notice.

(2) Please ask us when the required fastening range exceeds the recommended range or when it is around the lower limit.